

# Stainless Steel Sinks and Double-sinks

## SLUN 04E, SLUN 07E



SLUN 04E



SLUN 07E

### Characteristics:

- stainless steel wall hung sinks with integrated electronics
- water is flowing as long as hands are in the active range (max. range to 0,3 m)
- water stops flowing after removal of hands from the active range of sensor after adjustable time delay
- adjustable time delay from 0,25 to 7,75 sec.
- possibility of changing of time delay, active range and switching off by SLD 03
- water temperature regulation by angle valves or by thermostatic mixer
- material CrNi 18/10 (AISI-304)
- brushed finish

### Dimensions:

SLUN 04E

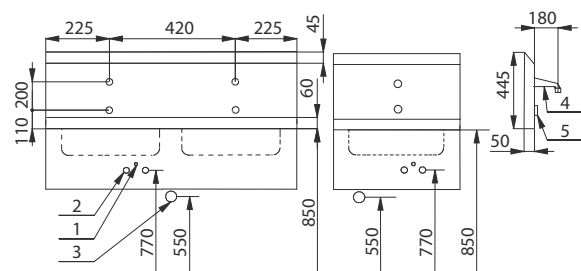
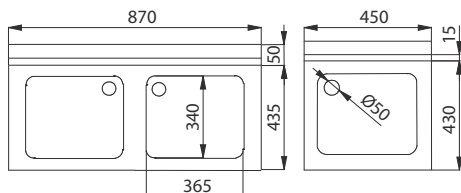

SLUN 07E

- 1 - power supply 24V DC
- 2 - water inlet (male thread G 1/2")
- 3 - waste outlet Ø 50 mm
- 4 - spout
- 5 - sensor

### Technical Specification:

- Operating voltage
- models with index E, ET 24V DC external battery 6V
  - models with index EB, ETB battery 6V
- Recommended flow pressure 0,1 - 0,6 MPa
- Rate of flow 12 l/min. (inf. data)
- Water inlet male thread G 1/2"
- Water temperature regulation
- models with index E, EB by angle valve
  - models with index ET, ETB by thermostic mixer

### Supply Specification:

- SLUN 04E** – supply No. **93041** stainless steel sink with integrated electronics and spout; electromagnetic valve (1 pc.);
- SLUN 04EB** – supply No. **93042** thermostatic mixer (1 pc.) (only for models with „T“ index); connecting hoses; angle
- SLUN 04ET** – supply No. **93043** valve with filter and non-return valve (2 pcs.); siphon; mounting set;
- SLUN 04ETB** – supply No. **93044** set of 4 pcs. of alkaline batteries (only for models with „B“ index)

- SLUN 07E** – supply No. **93071** stainless steel double-sink with integrated electronics and spouts (2 pcs.); electromagnetic
- SLUN 07EB** – supply No. **93072** valve (2 pcs.); thermostatic mixer (1 pc.) (only for models with „T“ index); connecting
- SLUN 07ET** – supply No. **93073** hoses; angle valve with filter and non-return valve (2 pcs.); siphon; mounting set;
- SLUN 07ETB** – supply No. **93074** set of 4 pcs. of alkaline batteries (only for models with „B“ index)

### Recommended Accessories:

- SLZ 01Y** – supply No. **05012** external power supply 230/24V DC for operating of max. 2 pcs. of SLUN 04E(T) or 1 pc. of SLUN 07E(T) (see page 118)
- SLZ 01Z** – supply No. **05011** external power supply 230/24V DC for operating of max. 4 pcs. of SLUN 04E(T) or 2 pcs. of SLUN 07E(T) (see page 118)
- SLZ 03** – supply No. **05030** switched power supply 230/24V DC for operating of max. 9 pcs. of SLUN 04E(T) or 4 pcs. of SLUN 07E(T) (see page 118)
- SLD 03** – supply No. **07030** universal remote control for an adjustment of parameters of all products with infra-red electronics (see page 115)
- SLA 36** – supply No. **06360** set of 4 pcs. of alkaline batteries (only for models with „B“ index)